



2021 Championship

Palm Springs, California Bike Course

3 miles/12.4 miles/24.8 miles/56 miles/112 miles

SPRINT: Saturday, October 23, 2021

- Bike: 12.4 miles (out-n-back)
 - 1) – Exit T1, L onto Cahuilla Park Rd.
 - 2) – R on Jefferson St.
 - 3) – R on 58th Ave.
 - 4) – R on Jackson St.
 - 5) – Turn around at 6.2 miles and return on same route to T2

OLYMPIC: Saturday, October 23, 2021

- Bike: 24.8 miles (out-n-back)
 - 1) – Exit T1, L onto Cahuilla Park Rd.
 - 2) – R on Jefferson St.
 - 3) – R on 58th Ave.
 - 4) – R on Jackson St.
 - 5) – L on 66th Ave.
 - 6) – Turn around at 12.4 miles and return on same route to T2

HALF: Saturday, October 23, 2021

- Bike: 56 miles (two out-n-backs)
 - 1) – Exit T1, L onto Cahuilla Park Rd.
 - 2) – R on Jefferson St.
 - 3) – R on 58th Ave.
 - 4) – R on Jackson St.
 - 5) – L on 66th Ave.
 - 6) – R on Pierce St.
 - 7) – Turn around at 15.35 miles and return to turn around at Half/Full turn around at IID Parking Lot to begin second out-n-back to return on original route to T2 in Lake Cahuilla Park

FULL: Saturday, October 23, 2021

- Bike: 112 miles (four out-n-backs)
 - 1) – Exit T1, L onto Cahuilla Park Rd.
 - 2) – R on Jefferson St.
 - 3) – R on 58th Ave.
 - 4) – R on Jackson St.
 - 5) – L on 66th Ave.
 - 6) – R on Pierce St.
 - 7) – Turn around at 16.3 miles and return to turn around at T2 to begin second, third and fourth out-n-backs to T2 in IID Parking Lot

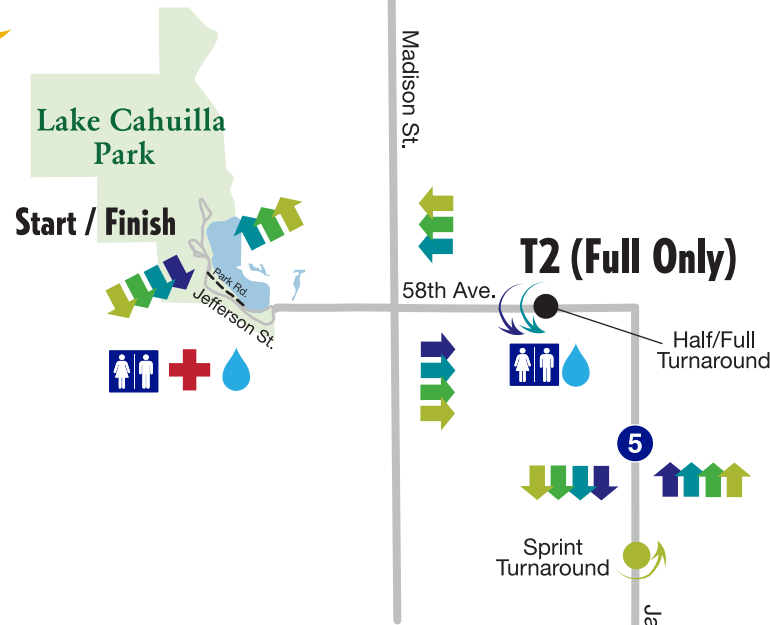

| Course Key | | | |
|------------|-----------|--|---------------|
| | = Sprint | | = Trail |
| | = Olympic | | = Aid Station |
| | = Half | | = Medical |
| | = Full | | = Porta-Potti |
| | | | = Mile Marker |

